

FOR LEASE DOWNTOWN OFFICE SPACE

214 Neilston Street – Columbus, OH 43215



PROPERTY DESCRIPTION

- 2,844 SF AVAILABLE
- CREATIVE LOFT SPACE
- 6 OFF-STREET PARKING SPACES
- 5 PRIVATE OFFICES, CUBICLE AREA, CONFERENCE ROOM AND KITCHENETTE
- MANY OTHER PARKING OPTIONS
- BUILT IN 1897

LEASE RATE: \$15.55/SF MG

contact information

Mike Simpson
tel 614 629 5236
msimpson@ohioequities.com

Main Office
605 S Front St Suite 200
Columbus, Ohio 43215
tel 614 224 2400
www.ohioequities.com

NAI Ohio Equities^{REALTORS®}
Commercial Real Estate Services, Worldwide.

The information contained herein has been given to us by the owner of the property or other sources we deem reliable. We have no reason to doubt its accuracy, but we do not guarantee it. All information should be verified prior to purchase or lease.

FLOORPLAN – 1st FLOOR

222 Neilston Street – Columbus, OH 43215

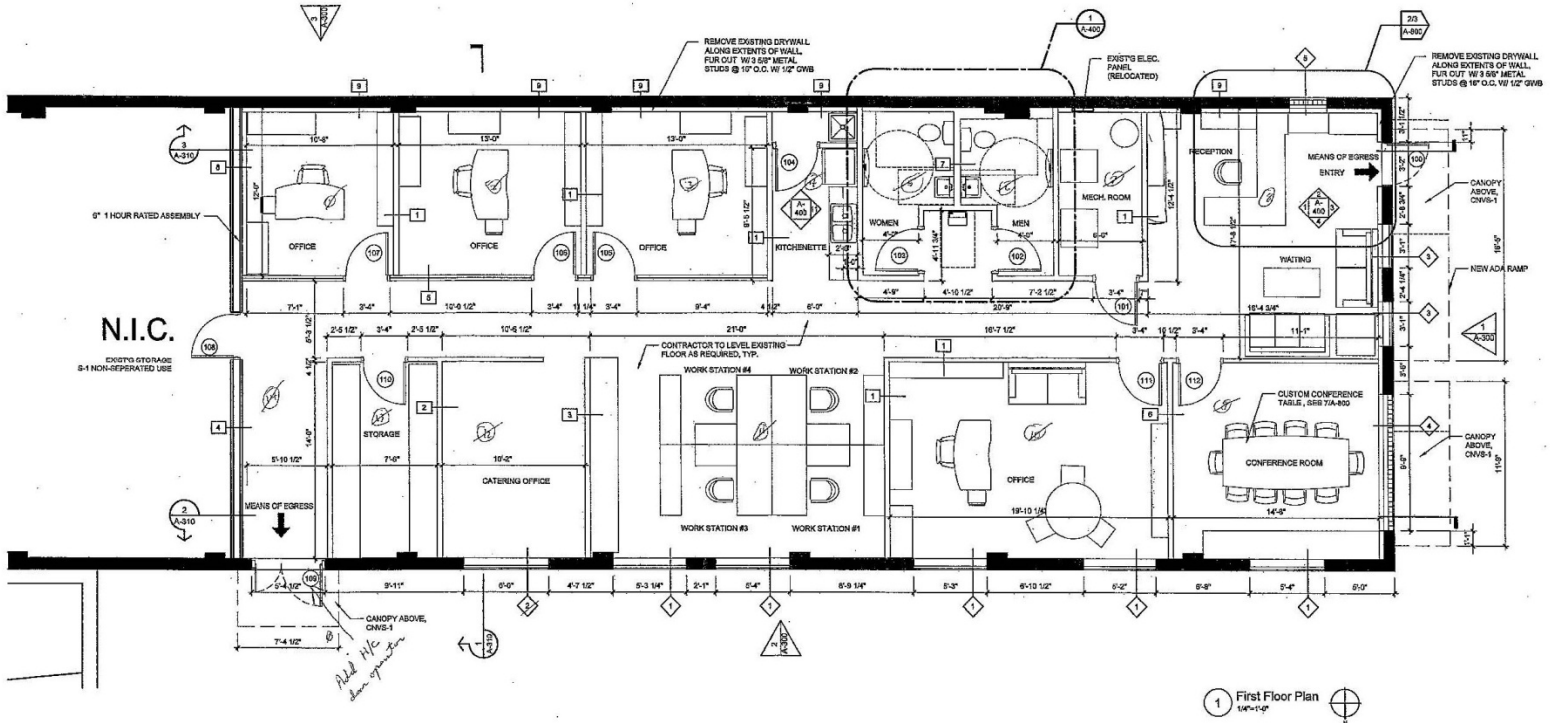

AERIAL IMAGERY & LOCATION MAPS

214 Neilston Street – Columbus, OH 43215



NAI Ohio Equities[®] REALTORS[®]
 Commercial Real Estate Services, Worldwide.

The information contained herein has been given to us by the owner of the property or other sources we deem reliable. We have no reason to doubt its accuracy, but we do not guarantee it. All information should be verified prior to purchase or lease.

contact information

Mike Simpson
 tel 614 629 5236
 msimpson@ohioequities.com