

**FOR LEASE**

# OFFICE WAREHOUSE BUILDING

1760 Frebis Avenue – Columbus, OH 43206

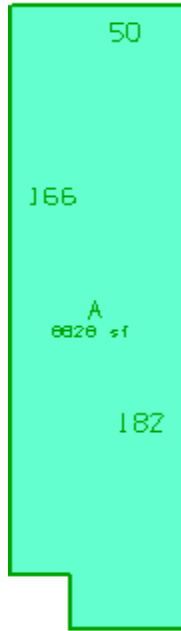
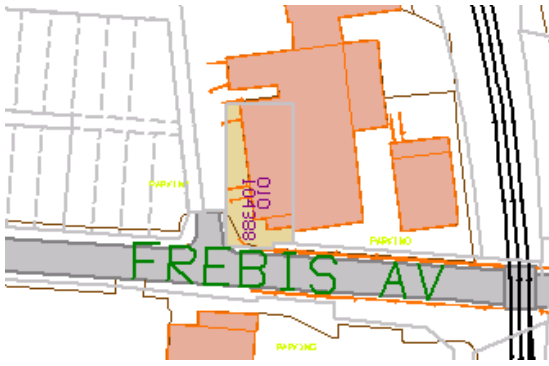

## PROPERTY DESCRIPTION

**BUILDING SIZE:** 9,050 SF  
**OFFICE SIZE:** 800 SF  
**ZONED:** M  
**LOT SIZE:** .38 ACRES  
**DOCKS:** 2 (8' X 9')  
**ELECTRIC:** 240V / 200 AMPS  
**YEAR BUILT:** 1979  
**CLEAR HEIGHT:** 16'

GOOD CLEAN BUILDING  
LOCATED OFF OF FREBIS, ONE BLOCK  
WEST OF ALUM CREEK

**LEASE RATE \$3.95 PSF MG**

### contact information

**Jon Downing** | tel 614 629 5232

[jdowning@ohioequities.com](mailto:jdowning@ohioequities.com)

**Curt Berlin SIOR** | tel 614 629 5221

[cberlin@ohioequities.com](mailto:cberlin@ohioequities.com)

**Dan Sheeran** | tel 614 629 5216

[dsheeran@ohioequities.com](mailto:dsheeran@ohioequities.com)

### Main Office

605 S Front St Suite 200

Columbus, Ohio 43215

tel 614 224 2400

[www.ohioequities.com](http://www.ohioequities.com)

**NAI** Ohio Equities REALTORS®

Commercial Real Estate Services, Worldwide.

The information contained herein has been given to us by the owner of the property or other sources we deem reliable. We have no reason to doubt its accuracy, but we do not guarantee it. All information should be verified prior to purchase or lease.

# FLOORPLAN

1760 Frebis Avenue – Columbus, OH 43206

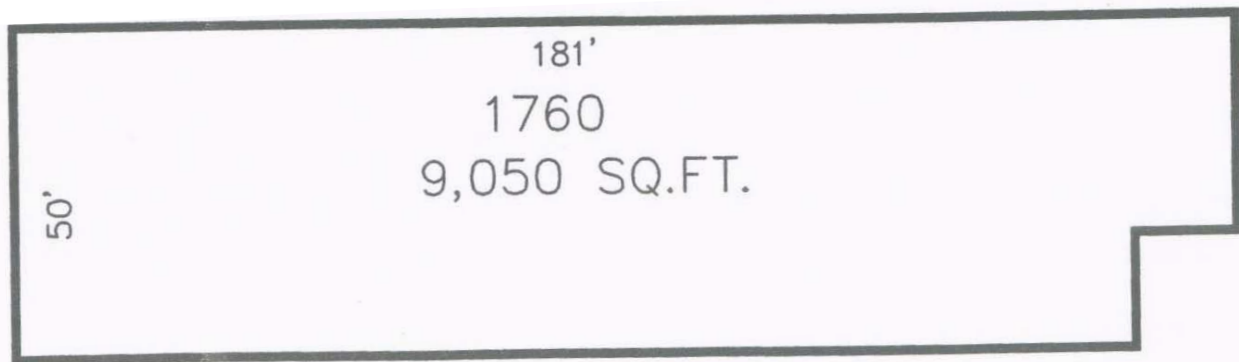

**Jon Downing**  
tel 614 629 5232  
jdowning@ohioequities.com

**Curt Berlin SIOR**  
tel 614 629 5221  
cberlin@ohioequities.com

**Dan Sheeran**  
tel 614 629 5216  
dsheeran@ohioequities.com

# AERIAL IMAGERY & LOCATION MAP

1760 Frebis Avenue – Columbus, OH 43206

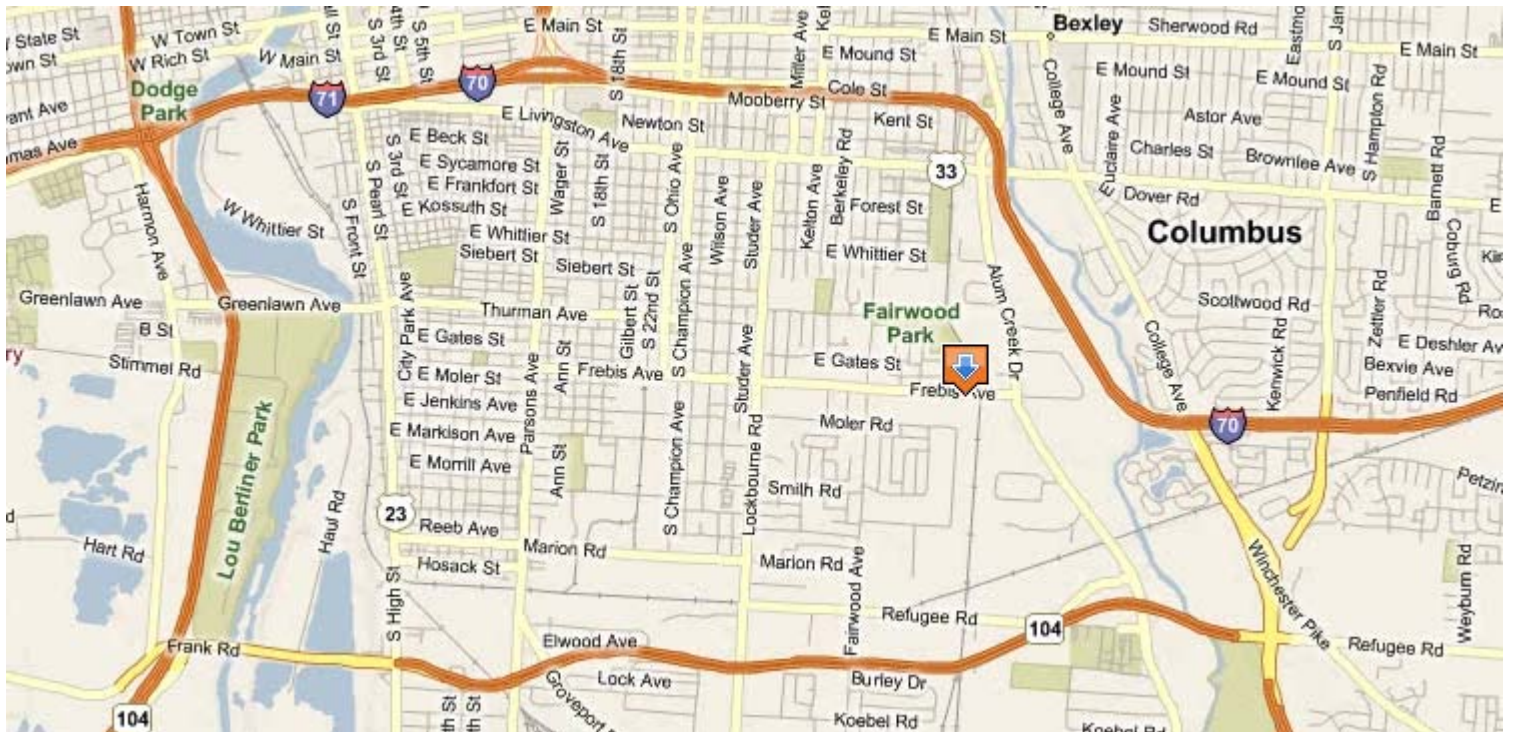

Jon Downing  
tel 614 629 5232  
jdowning@ohioequities.com

Curt Berlin SIOR  
tel 614 629 5221  
cberlin@ohioequities.com

Dan Sheeran  
tel 614 629 5216  
dsheeran@ohioequities.com

**NAI** Ohio Equities REALTORS®

Commercial Real Estate Services, Worldwide.

The information contained herein has been given to us by the owner of the property or other sources we deem reliable. We have no reason to doubt its accuracy, but we do not guarantee it. All information should be verified prior to purchase or lease.